

# ELLA Extractor

Extractor for SX-ELLA Esophageal Stents

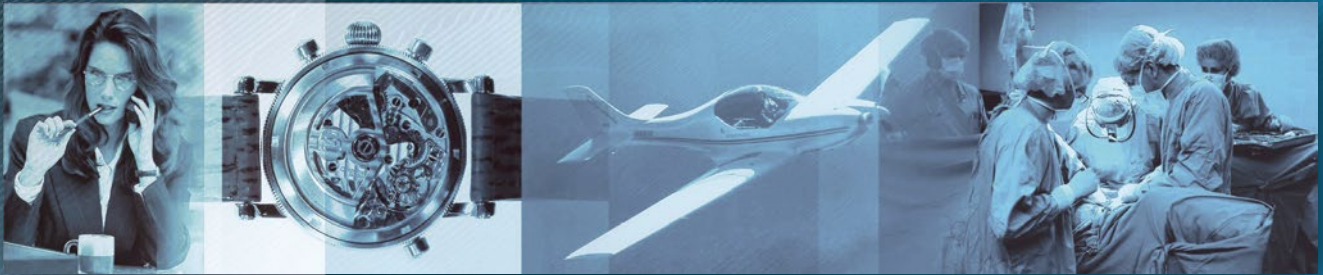

# ELLA Extractor



Simple and reliable removal system

Atraumatic stent retrieval

Allows removal of migrated stents from stomach

Radiopaque markers



3D animation



## Basic description

# Extractor for SX-ELLA Esophageal Stents - ELLA Extractor

ELLA Extractor is designed for extraction of SX-ELLA esophageal stents:

- ☑ SX-ELLA Stent Esophageal - Flexella
- ☑ SX-ELLA Stent Esophageal - Flexella Plus
- ☑ SX-ELLA Stent Esophageal HV - HV Stent
- ☑ SX-ELLA Stent Esophageal HV - HV Stent Plus
- ☑ SX-ELLA Stent Danis - Danis Stent
- ☑ Esophageal Stent Danis Seal

### Removal recommendations:

- ☑ Danis Stent should be removed within maximum of 7 days following implantation. Esophageal Stent Danis Seal should be removed within maximum of 14 days following implantation - after that period using extractor is **not recommended**.
- ☑ Removal of fully covered stents placed in benign strictures should be performed within 4 weeks after stent implantation.
- ☑ In addition ELLA Extractor may be used for retrieval of both fully and partially covered stents that migrated into stomach.

### Features and Benefits

- ☑ **Atraumatic stent capture** - stent is completely retrieved into overtube prior to removal; no shearing forces on esophageal wall.
- ☑ **Excellent radiopacity**- stainless steel cable and radiopaque markers on overtube - precise fluoroscopic control.
- ☑ **Unique design** - safe removal of stents from their original position or stents migrated into stomach.
- ☑ **Through-the-scope application** - extraction cable is designed for use through working channel of standard endoscope (2.8 mm); retrieval loop of stent is captured with arresting hook under direct vision.

### Additional description

9.4 mm (28 F) / 100 cm overtube with distal radiopaque marker.  
2.6 mm / 150 cm stainless steel extraction cable consisting of central wire with arresting hook and braided sheath.

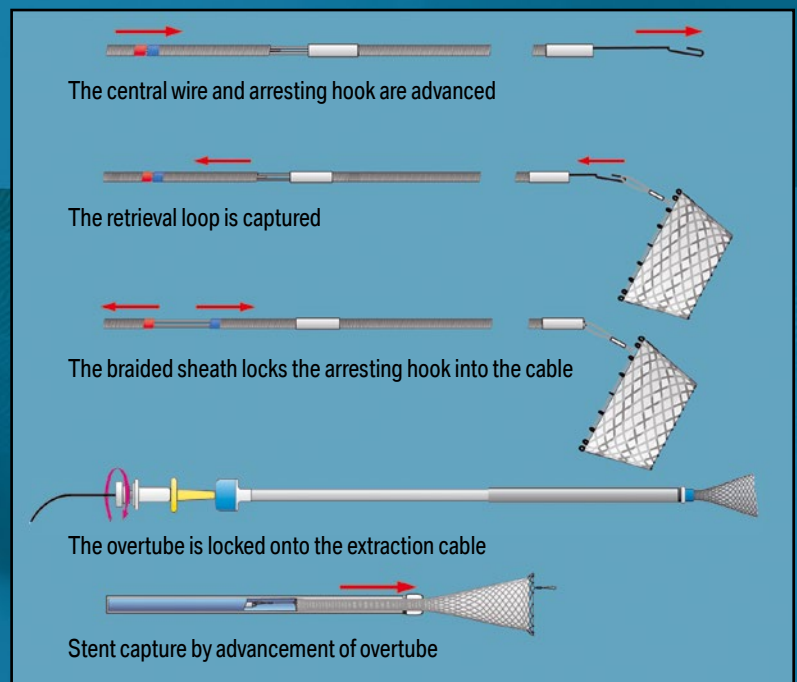
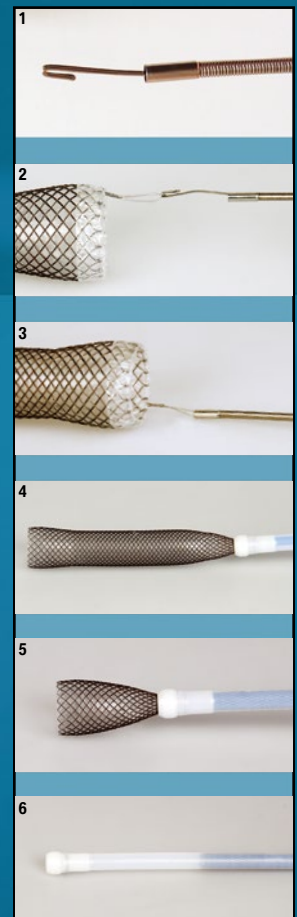
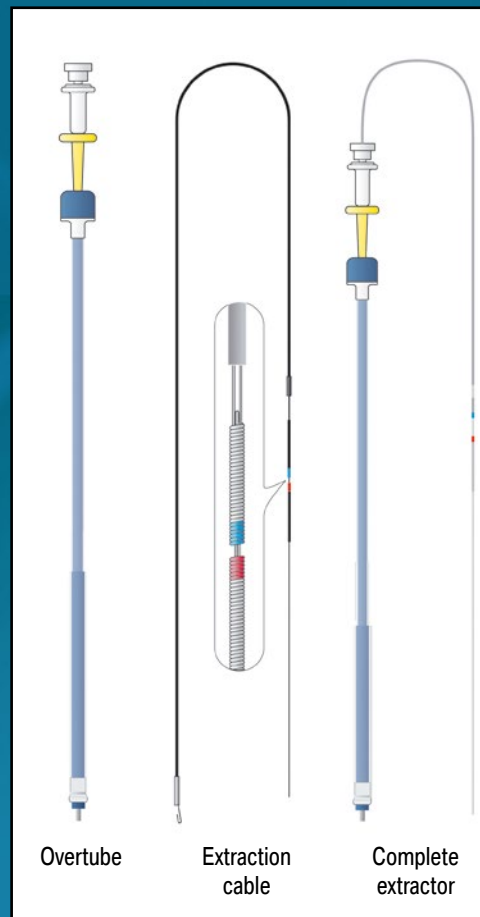
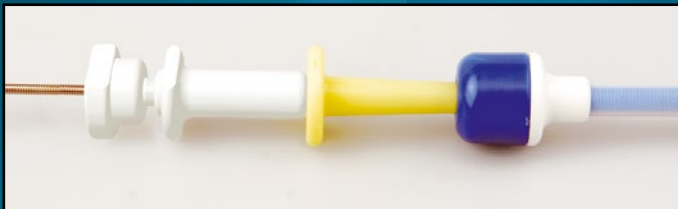
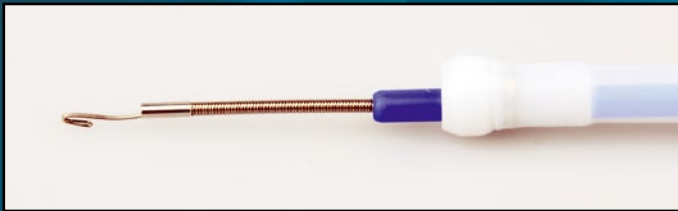

### Available sizes

REF No.	Extraction cable		Overtube	
	Outer diameter [mm]	Length[cm]	Length [cm]	Outer diameter [F]
015-01-28-1000	2.6	150	100	28

Distributor:

Manufacturer:

**ELLA-CS, s.r.o.**

Milady Horakove 504/45, Trebes  
500 06 Hradec Kralove, Czech Republic

Tel.: +420 495 279 111 Fax: +420 495 265 655  
E-mail: info@ellacs.eu URL: www.ellacs.eu